



İMAJ TEKNİK
ELEKTRİK ELEKTRONİK MALZ. SAN. VE TİC. LTD. ŞTİ



Minebea

SPECIFICATIONS

Load Cell for Commercial Scale

Load Cell
C2D1-100K~800K

SPEC.No.EN214051-D 1/2

● PERFORMANCE

Rated capacity	: 980.7 N{100 kgf} ~ 7.845 kN{800 kgf}
Safe overload	: 150 %R.C.
Ultimate overload	: 200 %R.C.
Rated output	: 2 mV/V ± 0.004 mV/V
Non-linearity	: 0.02 %R.O.
Hysteresis	: 0.02 %R.O.
Repeatability	: 0.02 %R.O.
Creep	: 0.025 %R.O./20 min
Creep recovery	: 0.025 %R.O./20 min

● ELECTRICAL

Excitation, recommended	: 12 V or less
Excitation voltage, at maximum	: 16 V
Zero balance	: ± 0.1 mV/V
Input resistance	: $420 \Omega \pm 40 \Omega$
Output resistance	: $350 \Omega \pm 3 \Omega$
Insulation resistance (between bridge and main body)	: 2 000 M Ω or more (DC50 V)

● TEMPERATURE

Temperature range, compensated	: -10 °C to 50 °C
Temperature range, safe	: -20 °C to 70 °C
Temperature effect on zero balance	: 0.05 %R.O./10 °C
Temperature effect on output	: 0.02 %LOAD/10 °C

● Cable

: $\phi 6.3$, 4-cores shielded 6 m cable directly attached.
Y-type solderless terminal is attached at the cable end.

● Class of protection

: Equivalent to IP65. (Main body only)

● Materials of the element

: Aluminium alloy

● Paint

: Painted with epoxy resin (Black)

● Durability

: 10^6 times with rated load

● Effect of eccentric load

:

- Refer to above figure as for the maximum size of loading plate
- The center of loading surface and also the center of load cell should be the same position.
- Error is within 0.02 %R.O. applied with 1/2 rated capacity at the position of 150 mm of eccentricity.

Note) R.O. means Rated Output and also R.C. means Rated Capacity.

Polarity of output will become plus(+) when the direction of compression load is applied.

If polarity change is required, change wiring of blue and green.

WIRING DIAGRAM

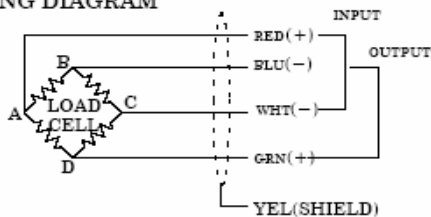

Maximum size of loading plate

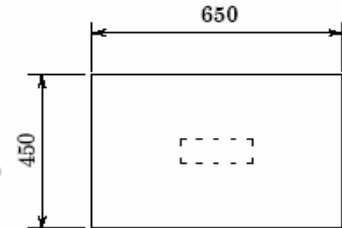

Unit : mm

Composition

Main body	1
Certificate	1

SPECIFICATION
Load Cell
C2D1-100K~800K

SPEC.No.EN214051-D 2/2

C2D1-600K~450K

C2D1-600K~800K

Table for P/No.

(Unit : mm)

P/No.	Rated capacity	Rated displacement	Natural frequency(Hz)	Weight (Approx.kg)
C2D1-100K	980.7 N (100 kgf)	0.13	450	1.9
C2D1-300K	2.942 kN (300 kgf)	0.24	570	1.9
C2D1-450K	4.413 kN (450 kgf)	0.30	620	1.9
C2D1-600K	5.884 kN (600 kgf)	0.43	450	3.45
C2D1-800K	7.845 kN (800 kgf)	0.46	500	3.50

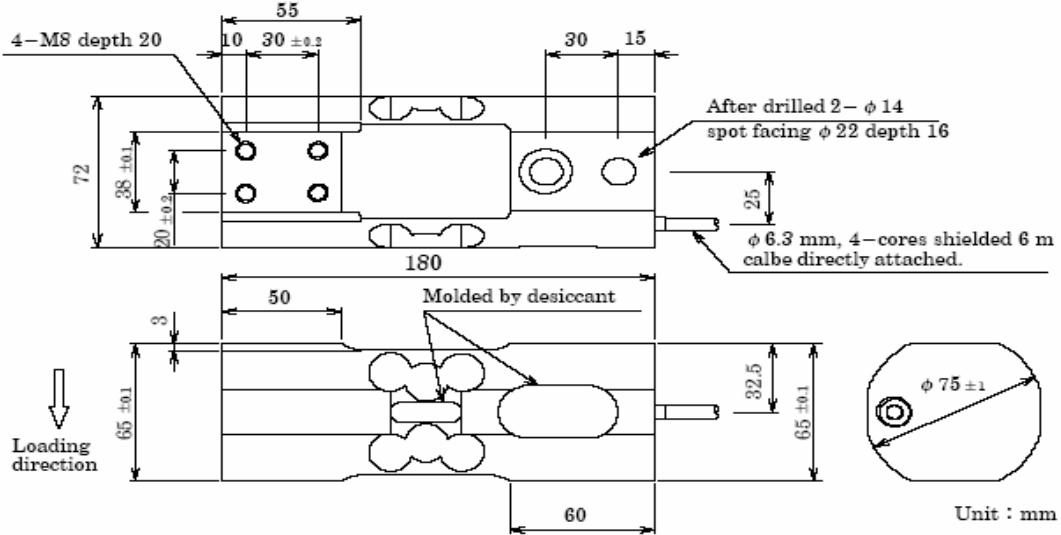
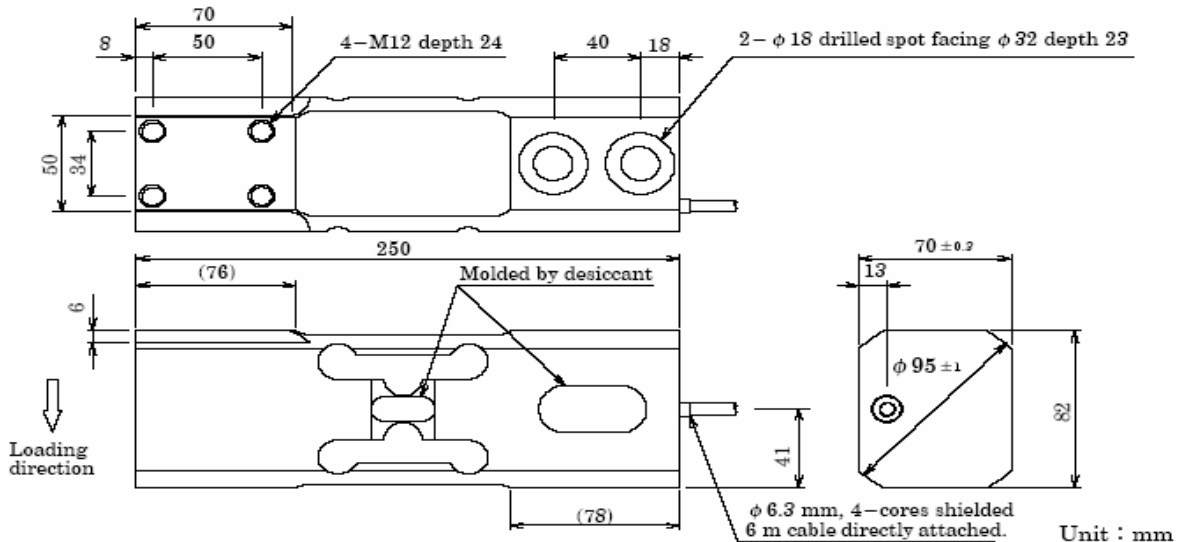
Specifications and outline dimensions and so on which have printed may subject to change for the purpose of improvement.