













## TECHNICAL SPECIFICATIONS

Conformity to Community Directives	2006/95/CE
Conformity to Standards	EN 60204-1 EN 60947-1 EN60947-5-1 EN 60529
Ambient temperature	Storage -40°C/+70°C Operational -25°C/+70°C
Protection degree	IP 65
Insulation category	Class II
Cable entry	Cable clamp M20
Operation frequency	3600 operations/hour max.
Markings	CE

## TECHNICAL SPECIFICATIONS OF THE SWITCHES

Utilisation category	AC 15
Rated operational current	3 A
Rated operational voltage	250 V
Rated thermal current	10 A
Rated insulation voltage	500 V~
Mechanical life	1x10 <sup>6</sup> operations
Terminal referencing	According to EN 50013
Connections	Screw-type terminals
Markings	CE - UL - (c)UL

## STANDARD LIMIT SWITCH CODES

CODE	NO. OF SWITCHES	ROD LENGTH	ACTUATING TRAVEL
PF48020001	2	300 mm	11-12 
PF48020005	2	250 mm	11-12 
PF48020006	2	200 mm	11-12 
PF48030001	3	300 mm	11-12 
PF48030002	3	250 mm	11-12 
PF48030003	3	200 mm	11-12 
PF48040001	4	300 mm	11-12 
PF48040006	4	250 mm	11-12 
PF48040007	4	200 mm	11-12 
			11-12 

## OVERALL DIMENSIONS

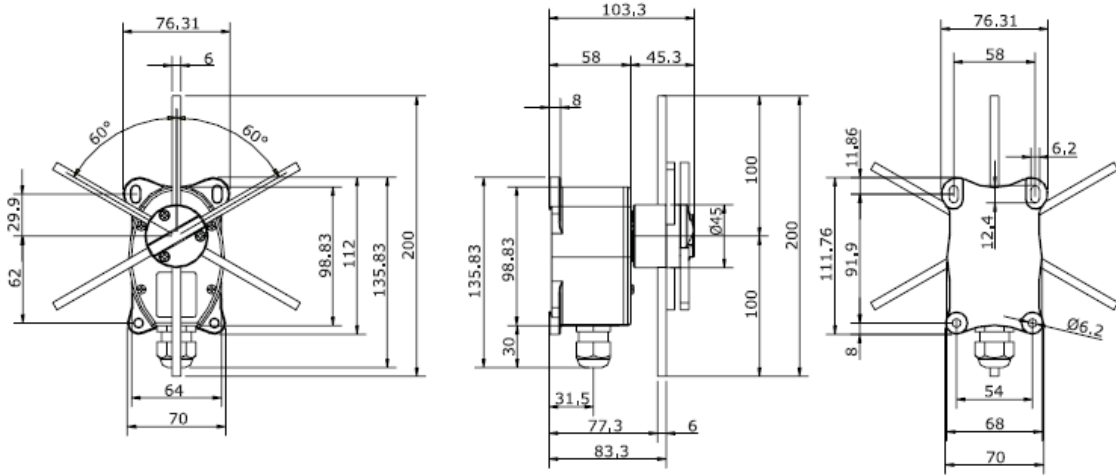

## MAXIMUM ACTUATING DIMENSIONS

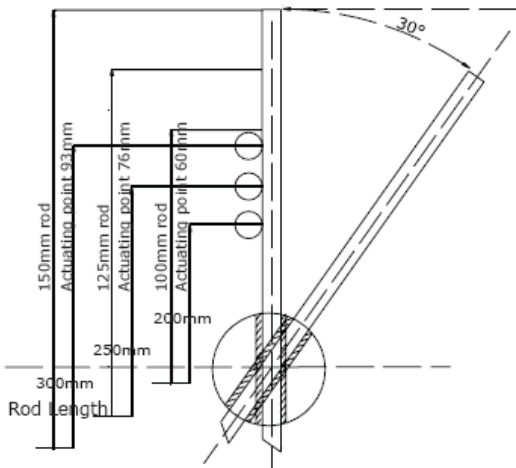

### Rods with 4 maintained positions

Pre-travel angle for rotation contact operation	34°
Maximum rotation angle for each maintained position	60°
Average angle for the mechanical tripping	30°
Maintained positions each	60°

In order to ensure proper operations, the dimensions shall not be increased; anyhow, they can be decreased, taking into account that the closer the impact point is to the center of the head, the higher the impact and the mechanical wear of rod and shaft are.

**DETAILED DRAWING**

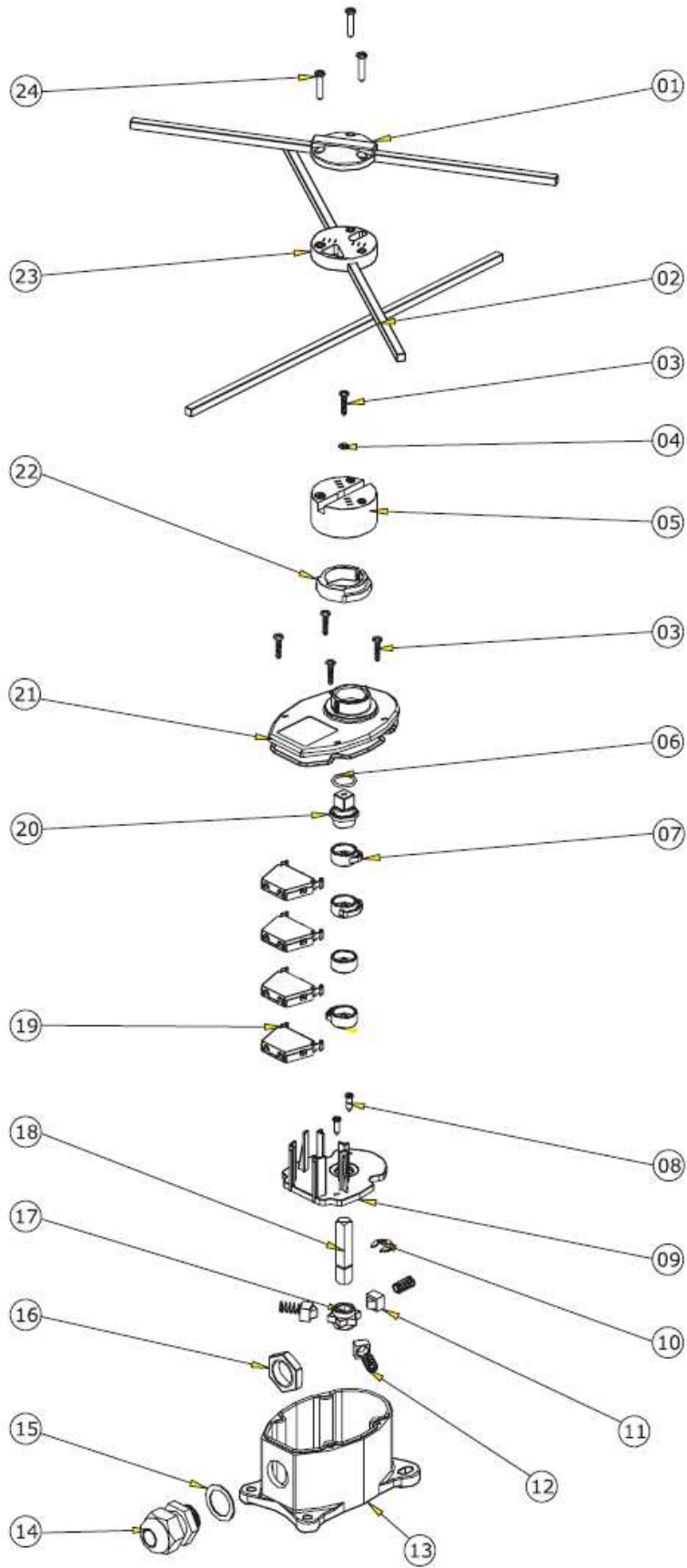

## COMPONENTS

REFERENCE	CODE	DESCRIPTION
01	PRSL9023PI	Upper rod support
02	PRTO3006PE	Rod 6x6x200 mm
	PRTO3011PE	Rod 6x6x250 mm
	PRTO3012PE	Rod 6x6x300 mm
03	PRVI0097PE	Screw 3.9x16
04	PRRN1012PE	Toothed washer
05	PRSL9022PI	Lower rod support
06	PRGU0048PE	O-ring 2056
07	PRSL7162PI	Cam 60° sx
	PRSL7163PI	Cam 60° dx
	PRSL7164PI	Cam 110° sx
	PRSL7165PI	Cam 110° dx
	PRSL7165PI	Cam for right-left slowing
08	PRVI0051PE	Screw 3.5x12
09	PRSL8732PI	Switch holder plate
10	PRRN1102PE	Elastic ring
11	PRSL7081PI	Pin for notch
12	PRMO2022PE	Spring
13	PRSL5080PI	Enclosure
14	PRPS0064PE	Cable clamp M20
15	PRGU0008PE	Cable clamp gasket
16	PRDA1004PE	Cable clamp nut
17	PRSL7161PI	Wheel for notches
18	PRTO0020PE	Shaft
19	PRSL1000PI	1NO switch
	PRSL1001PI	1NC switch
20	PRSL9674PI	Drive bush
21	PRSL5594PI	Cover with gasket
22	PRSL8552PI	Ring for rod support
23	PRSL9021PI	Middle rod support
24	PRVI0126PE	Screw 4x20

İN

**adresimiz  
değişti** Emekyemez Mah. Yüksek Minare Sk. No:8 / 17  
80020 Karaköy / İstanbul  
Tel:212/2359535  
Fax:212/2359537