



İMAJ TEKNİK
ELEKTRİK ELEKTRONİK MALZ. SAN. VE TİC. LTD. ŞTİ



YANKEE



YANKEE POSITION SENSOR

Yankee is an electronic position sensor that is interfaced with rotation elements and will return a signal according to the angular position. Every position of the shaft is univocally associated with a single analogue signal which can be in voltage, in current, PWM, or it can be with CAN OPEN output. With 4096 counts per revolution, measuring accuracy is guaranteed.

Forty years of experience in the sector of rotary limit switches have given life to a project that combines state-of-the-art industrial electronics with precision mechanics. Yankee is made with top-quality materials and with the best components available on the market to guarantee long service life, precision and repeat accuracy even in extreme conditions.

Yankee can be installed easily in 3 different ways: with joint, flange or radial anchoring elements. Mounting bores are standardized to market requirements to and with the most frequently used geometries. Based on customers' requests it is possible to provide different anchoring systems to suit any special need.

Yankee can be used in a variety of industrial sectors, from hoisting to automation, to meet any need in terms of registration and identification of modern production machines, wherever controls are needed, regardless of the nature of the mechanic system and its complexity, to reduce and unify the system of angular positioning sensors.



CABLE SPECIFICATIONS

Suggested cable

For the terminal connection, use a flexible cable suitable for the transmission of CAN BUS signals.

Refer to the typical values according to CiA Standard 301 (2000-06). "Can Open application layer and communication profile".

Version 4.01:

| | |
|----------------------------|-----------------------------|
| Characteristic impedance | 120 Ohm |
| Conductor resistance | 2,5 - 10m Ohm |
| Conductor section | 0,25 - 0,34 mm ² |
| Propagation delay | <= 5 ns/m |
| Relative propagation speed | >= 67% |
| Temperature | -20 + 75 °C |

OVERALL DIMENSIONS

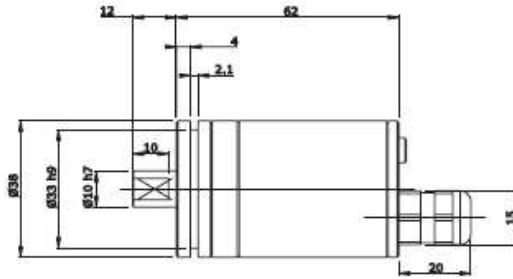

INSTALLATION DIAGRAMS

Diagram 1

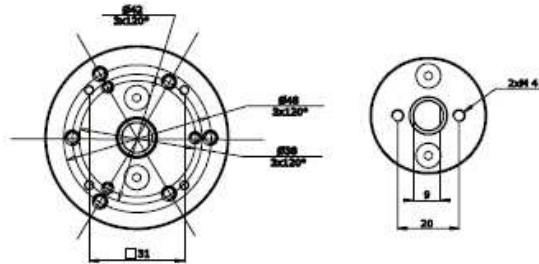

Diagram 2

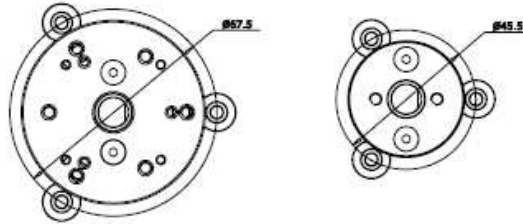

Diagram 3



adresimiz
değiştirdi

Tel:212/2359535
Fax:212/2359537

Emekyemez Mah.Yüksek Minare Sk. No:8 / 17
80020 Karaköy / İstanbul

